

# ZENITH 161-SERIES CARBURETORS

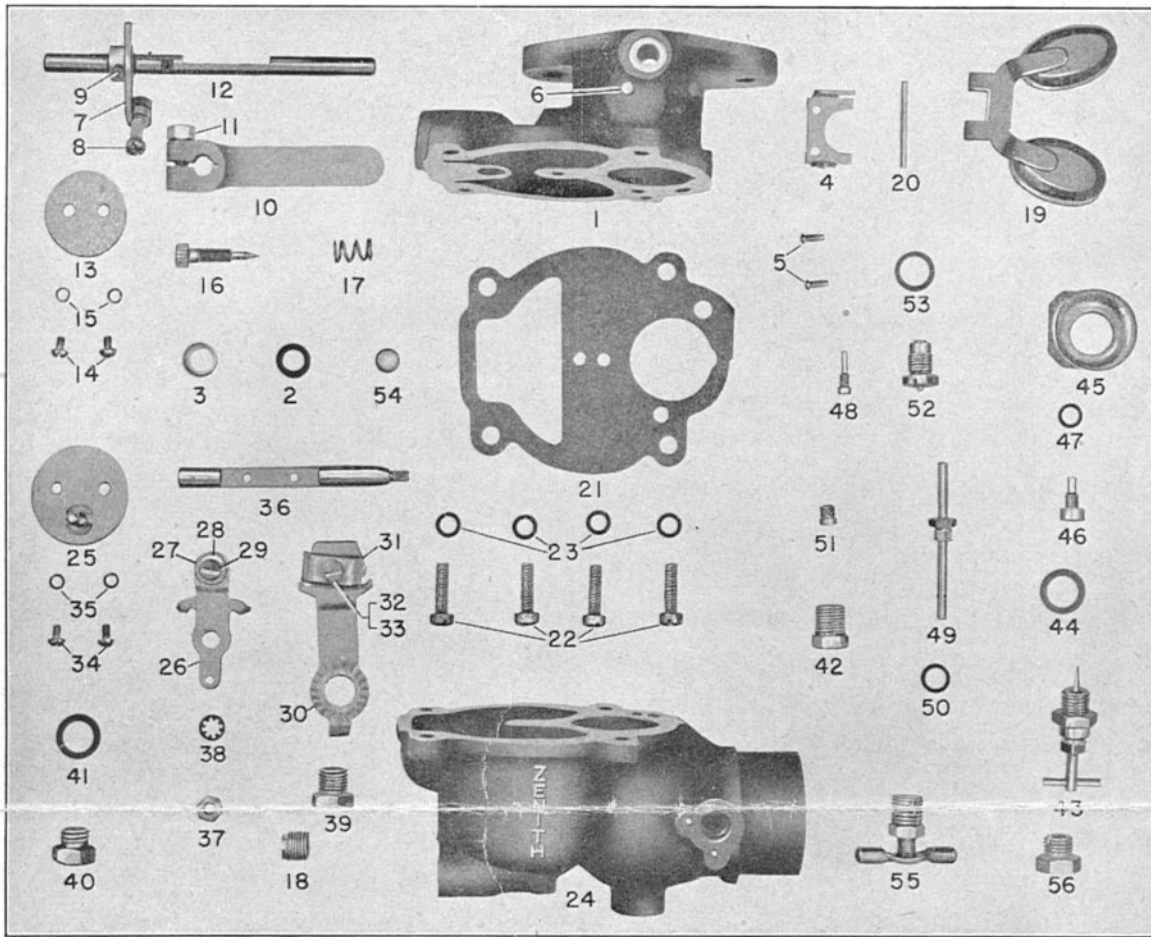

Use Gasket Set C181-66 - List Price \$0.33

## PARTS PRICE LIST FOR ZENITH 161-SERIES CARBURETORS

Ref. No.	Part No.	Part Name	List Price Each	Ref. No.	Part No.	Part Name	List Price Each
1	B2-140B-1	Throttle Body Assembly (161-7)	\$4.42	25	C101-17	Air Shutter Assembly	\$.55
1	B2-140D-1	Throttle Body Assembly (161J7)	4.42	26	C106-2	Air Shutter Lever Assembly	.39
1	B2-140C-1	Throttle Body Assembly (161X7)	4.42	27	CR134-1	Air Shutter Lever Swivel	.22
1	B2-140A-2	Throttle Body Assembly (161JX7)	4.42	28	CT52-1	Swivel Washer	.05
2	CT57-4	Packing Washer	.05	29	T1S8-6	Swivel Screw	.05
3	C131-4x2	Packing Retainer	.05	30	C109-2	Air Shutter Bracket	.39
4	CR88-8	Float Hinge Bracket	.11	31	C110-1	Air Shutter Bracket Wire Clamp	.05
5	T73-9	Bracket Drive Screw	.05	32	T1S8-10	Bracket Wire Clamp Screw	.05
6	CR121-8	Thro. Stop Pin L.H.	.05	33	T21S8	Bracket Wire Clamp Screw Nut	.05
6	CR121-26	Thro. Stop Pin R. H.	.05	34	T15B5-3	Air Shutter Retaining Screw	.05
7	*CR28-22	Throttle Stop Lever	.50	35	T41-5	Retaining Screw Lockwasher	.05
8	T1S8-10	Throttle Stop Screw	.05	36	C105-60	Air Shutter Shaft	.94
9	CT63-2	Throttle Lever Taper Pin	.05	37	T22S8	Air Shutter Shaft Nut	.05
10	C24-7x2	Throttle Clamp Lever	.94	38	T45-8	Air Shutter Shaft Nut Lockwasher	.05
11	T8S10-9	Throttle Clamp Lever Clamp Screw	.05	39	C140-2	Bracket Assembly Screw	.05
12	†C23-113	Throttle Shaft (161-7, 161X7)	.66	40	C138-24	Air Shutter Shaft Plug	.39
12	*C23-130	Throttle Shaft (161J7, 161JX7)	.66	41	T56-23	Shaft Plug Washer	.05
13	C21-88	Throttle Plate	.77	42	CT91-3	Bowl Drain Plug	.11
14	T15B5-3	Throttle Plate Screw	.05	43	C71-21	Main Jet Adjustment Assembly	1.00
15	T41-5	Throttle Plate Screw Lockwasher	.05	44	T56-23	Main Jet Adjustment Fibre Washer	.05
16	C46-25	Idling Adjusting Screw	.33	45	C38-51	Venturi (specify size)	1.22
17	C111-9	Idling Adjusting Screw Spring	.11	46	C52-6	Main Jet (specify size) where sizes 23 to 37 are used	.83
18	CT91-1	Fuel Inlet Pipe Plug 1/8"	.11	46	C52-6-1	Main Jet (specify size) where sizes 18 to 22 are used	.83
19	C85-28	Float Assembly	1.11	47	T56-24	Main Jet Fibre Washer	.05
20	C120-4	Float Axle	.11	48	C55-6	Idle Jet (specify size)	.55
21	C142-16	Bowl to Body Gasket	.11	49	C66-47	Main Discharge Jet (specify size)	.66
22	T1S10-10	Bowl to Body Assembly Screw	.05	50	T56-52	Discharge Tube Fibre Washer	.05
23	T41-10	Bowl to Body Assembly Screw Lockwasher	.05	51	C77-18	Well Vent (specify size)	.28
24	B3-85A	Fuel Bowl Assembly (161-7, 161X7, 161XX7)	5.55	52	C81-17	Fuel Valve and Seat Assembly (specify size)	.83
24	B3-85A-1	Fuel Bowl Assembly (161J7, 161JX7)	5.55	53	T56-20	Fuel Valve Seat Fibre Washer	.05

\*Part of C29-283 Throttle Lever and Shaft Assembly.

†Part of C29-282 Throttle Lever and Shaft Assembly.

VISIT WWW.CARBRESCUE.COM

VISIT WWW.CARBRESCUE.COM

**Special Parts for 161-Series Carburetors as used by Allis-Chalmers Manufacturing Co.**

**161J7—09705, 09706**

**161X7—09707**

Ref. No.	Part No.	Part Name	List Price Each
1	B2-138B-1	Throttle Body Assembly (161J7)	\$4.42
1	B2-138C-1	Throttle Body Assembly (161X7)	4.42
54	CR37-1x1	Shaft Hole Plug	.05
7	CR27-15-2	Throttle and Stop Lever Assembly (161J7)	.55
7	CR27-47-1	Throttle and Stop Lever Assembly (161X7)	.44
12	C23-100	Throttle Shaft (161J7)	.66
12	C23-101	Throttle Shaft (161X7)	.66
24	B3-85C-1	Fuel Bowl Assembly (161X7)	5.55
24	B3-85C-2	Fuel Bowl Assembly (161J7)	5.55
55	CT150-1	Drain Cock Assembly (09706-09707)	.28
56	C138-23	Lower Plug	.39
26	C106-109	Air Shutter Lever Assembly (161J7)	.44
26	CR24-87	Air Shutter Lever Assembly (161X7)	.44
29	T8S8-6	Swivel Screw	.05
6	CR121-21	Throttle Stop Pin (0-9706, 0-9705)	.05
	CT63-2	Air Shutter Lever Taper Pin (not illustrated)	.05
	C108-72	Air Shutter Lever and Shaft Assy. (0-9705, 0-9706) (not illustrated)	1.00
	C108-73	Air Shutter Lever and Shaft Assy. (0-9707) (not illustrated)	.83

ALL OTHER PARTS INTERCHANGEABLE

**Special Parts for 161JX7 Carburetor as used by J. I. Case Company**

**09667**

Ref. No.	Part No.	Part Name	List Price Each
1	B2-140A-1	Throttle Body Assembly	\$4.42
54	CR37-1x1	Shaft Hole Plug	.05
7	CR27-50-6	Throttle and Stop Lever Assembly	.66
12	C23-181	Throttle Shaft	.66
24	B3-85B	Fuel Bowl Assembly	5.55
26	CR106-54Ax2	Air Shutter Lever	.61
36	C105-88	Air Shutter Shaft	.44
	CT63-2	Air Shutter Lever Taper Pin (not illustrated)	.05
	C117-13	Air Shutter Lever Spring (not illustrated)	.11
55	CT150-1	Drain Cock Assembly	.28
45	C38-50A	Venturi Assembly (specify size)	1.22
49	C66-46	Main Discharge Jet (specify size)	.66
	C108-61	Air Shutter Lever and Shaft Assy. (not illustrated)	.94

ALL OTHER PARTS INTERCHANGEABLE

**Special Parts for Model 161XX7 Carburetor as used by Divco-Twin Truck Co.**

**09676**

Ref. No.	Part No.	Part Name	List Price Each
1	B2-138A	Throttle Body Assembly	\$4.42
54	CR37-1x1	Shaft Hole Plug	.05
7	CR27-129	Throttle and Stop Lever Assembly	.83
12	C23-309	Throttle Shaft	.66
	C112-6	Air Shutter Return Spring (not illustrated)	.11
42	CT91-3	Bowl Drain Plug	.11
56	C138-23	Lower Plug	.39
	C7-14	Flange Adapter (not illustrated)	1.11
	C141-9	Flange Adapter Gasket (not illustrated)	.11
	T39S31-8	Flange Adapter Assembly Screw (not illustrated)	.11
	T43-107	Adapter Assembly Screw Lockwasher (not illus.)	.05
45	C38-50A	Venturi Assembly (specify size)	1.22
49	C66-46	Main Discharge Jet (specify size)	.66

ALL OTHER PARTS INTERCHANGEABLE

**Special Parts for Model 161X7 Carburetor as used by International Harvester Co.**

**09748, 09749, 09750, 09751, 09752**

Ref. No.	Part No.	Part Name	List Price Each
1	B2-138C-2	Throttle Body Assembly (09748, 09749, 09750)	\$4.42
1	B2-138C-3	Throttle Body Assembly (09751, 09752)	4.42
54	CR137-1x1	Shaft Hole Plug	.05
7	CR27-65	Throttle and Stop Lever Assembly	.55
	CT52-24	Throttle Lever Spacer (not illustrated)	.05
12	C23-101	Throttle Shaft	.66
24	B3-85D-2	Fuel Bowl Assembly (09748, 09749, 09751, 09752)	5.55
24	B3-85D-1	Fuel Bowl Assembly (09750)	5.55
	C108-57	Air Shutter Shaft and Lever Assembly (not illus.)	.55
	CT150-1	Drain Cock Assembly (0-9748, 0-9749)	.28
56	C138-23	Lower Plug (09751, 09752, 0-9750)	.39
49	C66-50	Main Discharge Jet (specify size)	.83
	C150-17	Elbow and Filter Screen Assembly (09749, 09751, 09752) (not illustrated)	.55
20	C120-42	Float Axle	.11

ALL OTHER PARTS INTERCHANGEABLE



**ZENITH CARBURETOR DIVISION**

696 HART AVENUE



DETROIT 14, MICHIGAN

Manufacturers of Zenith Carburetors and Filters