

ZENITH 161-SERIES CARBURETORS

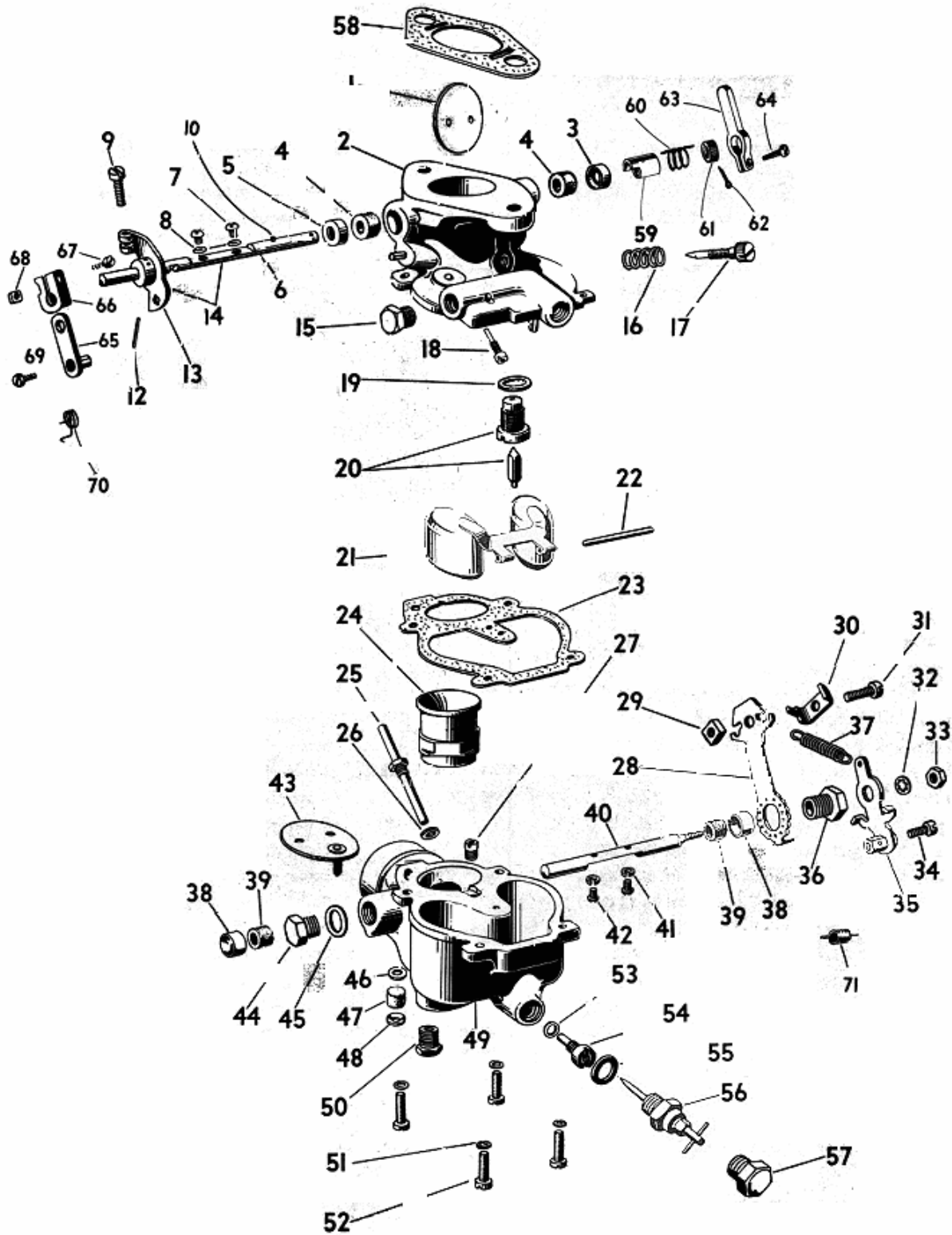

See reverse side for parts list

161 Series CARBURETOR PARTS LIST
(Models 161-7, 161X7, 161J7, 161JX7, 161XX7)

Ref. No.	Part No.	Part Name	Ref. No.	Part No.	Part Name
1	C21-88	Plate—throttle	40		*Shaft—choke
2	B2-	*Body—throttle	41	T41-5	Lockwasher—plate screw
3	CR37-1X1	Plug—throttle shaft hole	42	T15B5-3	Screw—choke plate
4	CT57-4	Washer—throttle shaft packing	43	C101-17	Plate—choke
5	C131-4X2	Retainer—packing	43	C101-60	Plate—choke (special light valve spring)
7	T15B5-3	Screw—throttle plate	44	C138-24	Plug—choke shaft hole
8	T41-5	Lockwasher—plate screw		CR37-1X2	Plug—choke shaft hole (cup type)
9	T1S8-10	Screw—lever stop		CR137-19	Plug—choke shaft hole (solid type)
10	C121-12	Pin—throttle shaft	45	T56-23	Washer—choke shaft hole plug
14	C29-	*Shaft and Lever—throttle	46	CT52-7	Washer—intake drain
15	CT91-3	Plug—fuel inlet	47	CT57-12	Washer—drain felt
15	C150-17	Elbow and Screen—fuel (I.H.C.)	48	CT93S-51	Retainer—felt washer
16	C111-9	Spring—idle adjusting needle	49	B3-	*Bowl—fuel
16	C111-17	Spring—idle adjusting needle (for C46-6 needle)	50	CT91-3	Plug—bowl drain
17	C46-25	Needle—idle adjusting		T150-1	Valve—bowl drain
17	C46-6	Needle—idle adjusting (No 12-32thd. I. H. C.)	51	T41-10	Lockwasher—bowl to body screw
18	C55-6-	†Jet—idle (specify size)	52	T1S10-10	Screw—bowl to body
19	T56-20	Washer—fuel valve seat	53	T56-24	Washer—main jet
20	C81-17-	†Valve and Seat—fuel (specify size)	54	C52-6-	†Jet—main (specify size)
21	C85-	*Float	55	T56-23	Washer—main passage plug
22	C120-4	Axle—float (brass)	56	C71-21	Adjustment—main jet
22	C120-42	Axle—float (stainless steel)	57	C138-23	Plug—main passage
23	C142-16	Gasket—bowl to body	58	C141-4-5	Gasket—flange (161-7)
24	C38-	†*Venturi (specify size)	58	C141-4-6	Gasket—flange (161X7)
25	C66-	†*Jet—discharge (specify size)	59	CR26-61	Bushing—throttle lever (brass)
26	T56-52	Washer—discharge jet	59	C26-81	Bushing—throttle lever (steel)
27	C77-18-	†Vent—well (specify size)	60	C117-27	Spring—throttle lever (R. H. coil)
28	C109-	*Bracket—choke	61	CR115-10	Retainer—spring
29	T21S8	Nut—clamp screw	62	T61-4	Cotter pin
30	C110-1	Clamp—bracket tube	63	C24-	*Lever—throttle clamp
31	T1S8-10	Screw—tube clamp	64	T8S10-9	Screw—lever clamp
32	T45-8	Lockwasher—shaft nut (No. 8)	65	C25-18X2	Lever—floating
32	T41-10	Lockwasher—shaft nut (No. 10)	66	C25-98AX2	Stop—floating lever
33	T22S8	Nut—choke shaft (No. 8-36 thd.)	67	T1S10-12	Screw—stop clamp
33	T22S10	Nut—choke shaft (No. 10-32 thd.)	68	T24S10	Nut—clamp screw
34	T1S8-6	Screw—swivel	69	T8S8-7	Screw—swivel
35		*Lever—choke	70	C117-6	Spring—floating lever (R. H.)
36	C140-2	Screw—bracket assembly	70	C117-8	Spring—floating lever (L. H.)
36	C140-7	Screw—bracket assembly (packed)	71	C117-13	Spring—choke lever (L. H. 6 coils)
37	C112-6	Spring—choke lever		C117-18	Spring—choke lever (L. H. 5½ coils)
38	C131-4X2	Retainer—packing		C117-36	Spring—choke lever (R. H. 5½ coils)
39	CT57-4	Washer—shaft packing		CR9-13	Bushing—throttle shaft
				C181-66	Gasket set
				K501	Basic repair kit

* Refer to Specification Bulletin for complete part number or specify carburetor assembly number. † Calibrated part—specify size. Zenith service parts can be obtained promptly through our central and service distributors located in principal cities.

ZENITH CARBURETOR DIVISION

696 HART AVENUE



DETROIT 14, MICHIGAN

Manufacturers of Zenith Carburetors and Filters

VISIT WWW.CARBRESCUE.COM